



Advanced Components  
for Automation

**tecnomors**



Organi di presa per bottiglie • Bottle grippers

# • ORGANI DI PRESA PER BOTTIGLIE • BOTTLE GRIPPERS

## • SCHEMA DI FUNZIONAMENTO • OPERATIONAL DIAGRAM

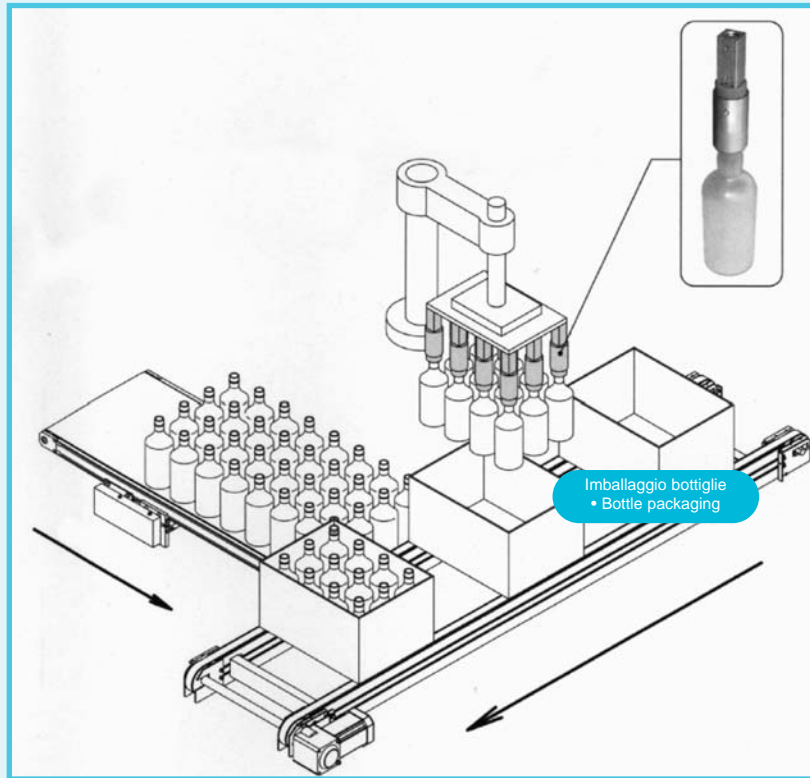
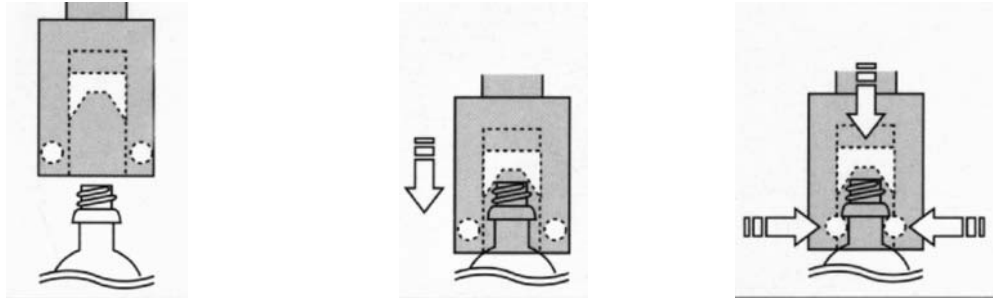

### DATI TECNICI

	RCD524SE	RCD524DE	RCD526SE	RCD526DE
Azionamento pneumatico	semplice effetto	doppio effetto	semplice effetto	doppio effetto
Forza di bloccaggio a 5 bar	.747 N	.919 N	.1961 N	.1981 N
Pressione di esercizio	.2-6 bar	.2-6 bar	.2-6 bar	.2-6 bar
Peso	.0.4 Kg	.0.4 Kg	.0.6 Kg	.0.6 Kg
Temperatura di esercizio	.5-60 °C	.5-60 °C	.5-60 °C	.5-60 °C
Codice articolo	.OP524SEB	.OP524DEB	.OP526SEB	.OP526DEB

### SPECIFICATIONS

	RCD524SE	RCD524DE	RCD526SE	RCD526DE
Functioning pneumatic	single effect	double effect	single effect	double effect
Theoretical opening couple per jaw at 6 bar	.747 N	.919 N	.1961 N	.1981 N
Working pressure	.2-6 bar	.2-6 bar	.2-6 bar	.2-6 bar
Weight	.0.4 Kg	.0.4 Kg	.0.6 Kg	.0.6 Kg
Working temperature	.5-60 °C	.5-60 °C	.5-60 °C	.5-60 °C
Article code	.OP524SEB	.OP524DEB	.OP526SEB	.OP526DEB